



FUWEI

ENERGY

Component	Positive plate	Negative	Container	Cover	Safety Valve	Terminal	Separator	Electrolyte
Raw Material	Lead dioxide	Lead	ABS	ABS	Rubber	Copper	AGM	GEL

Performance characteristics

Nominal Voltage 2V

Number of cell one

Nominal Capacity at 25 °C/77 °F

20Hr at 11.3 A to 10.75V-- 225 Ah

5Hr at 36.1 A to 10.5V-- 181 Ah

1Hr at 139 A to 9.6V-- 139 Ah

Internal Resistance

Fully charged battery at 25 °C

≤ 3.6 mΩ

Average Self-discharge at 20 °C/68 °F

<3% lost of capacity per month

Operating Temperature range:

Discharge at -20~60 °C

Charge at -10~60 °C

Storage at -20~60 °C

Max. discharge current at 25 °C: 3375 A(5s)

Charge Methods constant voltage charge at 25 °C

Cycle use---2.4~2.45V/cell;

Maximum initial charging current 67.5 A

Temperature compensation

-5mV/cell/ °C

Standby use---2.25~2.30V/cell

Temperature compensation

-3mV/cell/ °C

Cycle life is 1800 cycles @ 30% D.O.D

	Length	Width	Height	Total H	Weight	Terminal
mm/Kg	522	269	220	244	62	F12
inch/lb	20.6	10.59	8.66	9.61	137	M8

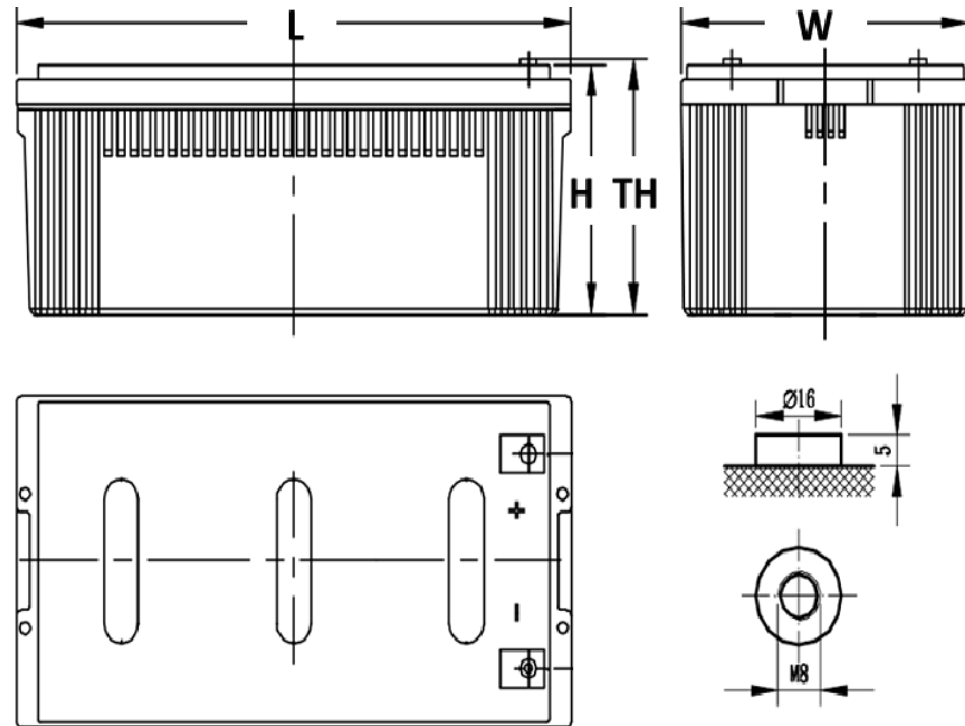



FUWEI

ENERGY

You can expect our batteries meet with the standards JIS, DIN, IEC60986-21/22 & BS6290-4.

Discharge Data

Discharge Constant Current (Amperes at 77°F /25°C)																									
End Point	5mi	10mi	15mi	20mi	25mi	30mi	35mi	40mi	45mi	50mi	55mi	1h	1.5h	2h	2.5h	3h	4h	5h	6h	7h	8h	9h	10h	12h	20h
1.60V	0	525	402	323	280	245	214	192	176	162	151	139	101	82.2	68.3	59.5	47.3	39.4	34.1	30.7	27.1	24.5	22.8	19.2	11.6
1.65V	0	492	379	306	264	230	204	183	168	154	145	132	97.1	78.8	65.6	57.2	45.9	38.0	33.3	29.6	26.6	24.0	22.1	18.7	11.5
1.70V	0	460	355	287	248	216	192	173	159	146	138	126	93.7	76.1	63	55.2	44.4	37.1	32.3	28.9	25.8	23.5	21.7	18.4	11.3
1.75V	0	427	331	268	231	203	182	163	150	138	129	120	89.3	72.5	60.9	53.3	42.9	36.1	31.5	28.2	25.2	23.1	21.3	18.2	11.3
1.80V	0	394	307	250	214	188	171	153	140	129	123	113	85.8	69.1	58.6	51.2	41.6	35.2	30.7	27.6	24.5	22.6	21.0	17.9	11.1

Discharge Constant Power per cell (Watts at 77°F /25°C)																									
End Point	5mi	10mi	15mi	20mi	25mi	30mi	35mi	40mi	45mi	50mi	55mi	1h	1.5h	2h	2.5h	3h	4h	5h	6h	7h	8h	9h	10h	12h	24h
1.60V	0	937	719	580	502	438	385	347	319	293	276	254	188	155	129	113	91.9	77.3	67.8	60.1	54	48.8	44.7	37.8	21.2
1.65V	0	884	680	549	475	415	368	331	305	280	265	245	182	150	125	110	89.3	75.4	66.2	58.8	52.8	48.0	44.1	37.4	20.9
1.70V	0	825	639	518	448	392	350	314	289	267	253	234	176	144	122	107	87	73.7	64.5	57.5	51.6	47.0	43.5	36.9	20.8
1.75V	0	770	601	487	421	369	332	298	274	254	240	224	170	139	118	103	84.7	71.8	62.8	56.3	50.2	46.2	42.8	36.4	20.5
1.80V	0	713	560	457	394	345	313	281	258	240	229	214	164	132	113	99.8	82.2	70	61.1	55	49	45.4	42.2	35.9	20.3

Note: The above characteristics data are average values obtained within three charge/discharge cycles not the minimum values.

All data shall be changed without notice. FUWEI reserves the right to explain and update the information contained hereinto.

Application

- UPS
- Telecom Systems
- Electric Wheelchair
- Power Station
- Military Equipment
- Emergency Power System
- Railway System

General Features

- Environmentally friendly
- Long Service Life, in Float and Cyclic
- Lower internal Resistance
- High Reliability and Good Quality
- International Standard, JIS and DIN
- lead-tin-calcium alloy grids for long service life
- Thick pasted plates with high quality





FUWEI

ENERGY

<http://www.fwny.net/en/>

6-CNJ-225 12V225Ah

